

FOCUS 1

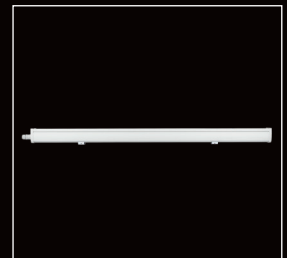

DESCRIPTION

FOCUS 1 industrial linear luminaire delivers superior illumination for large-scale spaces with ceiling heights of up to 15 meters. Designed for energy efficiency and precision, it features DALI control and boasts an IP66 rating, ensuring durability in demanding environments. With an operating temperature range of -20°C to +50°C, it is built for reliable performance in various conditions. Available in power options from 80W to 150W and multiple length configurations, FOCUS 1 adapts to diverse lighting needs. It supports both pendant and ceiling mounting.

APPLICATIONS

FOCUS 1 is ideal for high-bay environments such as warehouses, factories, bus stations, airports, parking lots, car washes, gymnasiums, sports venues and cold storage facilities.

BENEFITS

- **Reliable producer:** Designed, developed and manufactured by ENIM, a trusted EU producer
- **Exceptional Efficiency:** High-performance LEDs deliver up to 162 lm/W, ensuring maximum brightness with minimal energy consumption.
- **Versatile Power Options:** Available in 80 W to 150 W configurations, adaptable to various lighting needs.
- **Adaptable Optics:** Different optical options provide tailored illumination for diverse applications.
- **Intelligent Control:** DALI compatibility and motion sensors enhance energy savings and user convenience.
- **Engineered for Longevity:** Heat sink: aluminum extrusion, coated Mounting bracket: steel ensure durability, with a lifespan of up to 100,000 hours (L90 B10).
- **Rugged Protection:** IP66-rated for full resistance to dust and powerful water jets.
- **Compact & Convenient:** Simple design for easy integration into various environments.
- **Flexible Installation:** Supports pendant (with optional extended cable) and ceiling mounting.

TECHNICAL INFORMATION:





| | | | |
|-------------------|-------------|---------------------------|-------------------------------|
| ELECTRICAL | V | Input voltage | 198 ~ 264 VAC / 170 – 280 VDC |
| | Hz | Rated voltage | 50-60 Hz |
| | W | Luminaire wattage | 80 to 150 |
| | Cosφ | Power factor | ≥ 0,95 |
| OPTICAL | Lm | Luminous flux | 12240-24150 |
| | Lm/W | Luminous efficacy | Up to 162 |
| | K | Color temperature | 4000 |
| | Tg | Performance temperature | 25 °C |
| | C° | Ambient temperature range | - 20°C ≤ Ta ≤ +50°C |
| | CRI | Color rendering index | ≥80 |

| Number of LED's | 4X12 | 5X12 | 6X12 | 7X12 |
|-------------------------|-------------|-------------|-------------|-------------|
| Power | 80 | 100 | 120 | 150 |
| Lumious Flux, Lm | 12240-12720 | 15400-16200 | 18360-19320 | 22950-24150 |
| Efficacy, Lm/W | 153-159 | 154-162 | 153-161 | 153-161 |

| | |
|--|------------------------------------|
| Chromatic tolerance (original MacAdam) | Not higher than 5 |
| Life expectancy L/B | L90 B10 by 100000 hrs (Ta = 25 °C) |

| | | | |
|----------------|----------------------|---|--------------------|
| HOUSING | Size | 710 x 85 x 70 mm (80W); 890 x 85 x 70 mm (100W); 1060 x 85 x 70 mm (120W); 1230 x 85 x 70 mm (150W) | |
| | Weight | Max 2,7 kg | |
| | Body material | Heat sink: aluminum extrusion, coated; mounting bracket: steel, ensuring durability | |
| | Protection | IP66 | |
| | Installation | Ceiling mounting | Pendant (optional) |



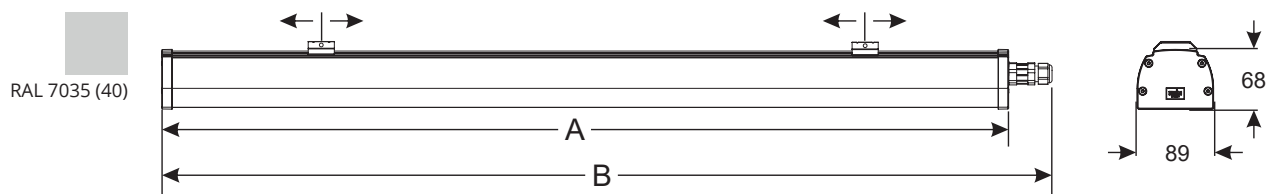



| | | |
|---------------|---|---|
| OPTICS | Light source | LEDs 5050 |
| | Optics | Asymmetric optics lens |
| | Optics type | Very carefully selected optics suppliers, the optics are transparent to ensure minimal light loss |
| | Maintenance | Optical module sealed for life. No internal cleaning required |
| | Protection against light pollution | 0 candela light emission above 90° |

| | | |
|---------------|---|--|
| DRIVER | Input voltage | 198 ~ 264 VAC / 170 – 280 VDC |
| | Intelligent temperature Guard (ITG) | The intelligent temperature guard protects the LED driver from thermal overheating by reducing the output power or switching it off if the luminaire or ballast operates beyond its thermal limits |
| | Overvoltage with a variable surge protection | Up to 2 kV, (4kV optional) |
| | Interfaces | PRESET SENSOR, DALI SENSOR, DALI |

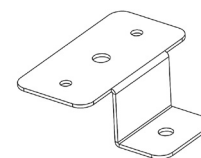
| | | |
|-----------------|--------------------|-------------------------|
| OPTIONAL | Accessories | |
| | Code | Name |
| | MET0397 | FOCUS_Z_bracket RAL7035 |



| | | |
|----------------|-----------------------------|---|
| REMARKS | CLO | The light output of an LED module decreases over its lifetime. The Constant Light Output (eCLO) function compensates for this natural decline by constantly increasing the output current of the LED driver throughout its lifetime |
| | Power factor (Cosφ) | ≥ 0.95 |
| | Recommended mounting height | Up to 15 m |
| | | Luminaires are ready to install |
| | | |

LOGISTIC DETAILS:

| Full pallet size/cm L*W*H | Number of luminaires per row | Number of rows | QTY per pallet/pcs |
|------------------------------|------------------------------|----------------------|--------------------|
| 120 X 80 X 135 | 3 | 10 | 30 |
| Volume per pallet | | Kg per pallet | |
| 1,392 m³ | | Netto | Brutto |
| | | 81 | 90 |

